

## XPC

Characteristics

- double break switching
- > 3 mm contact gap
- long overtravel
- faston terminals

Rating

120 VAC, 6 A  
240 VAC, 3 A

Dimensions (mm)

30 × 30 × 13

Actuator

- plunger

Approvals

CE



## Preferred Range

Ordering Reference	Actuating Force (N)	Operating position (mm)	Terminal	Circuit	Actuator	Contacts	Electrical rating
XPC24	6,0	13,5	Faston	CO	Straight plunger	AgSnO <sub>2</sub>	Up to 120 VAC, 6 A

## Specifications

Housing	Flame-retardant glass-fibre reinforced nylon
Plunger	Flame-retardant glass-fibre reinforced nylon
Mechanism	Snap-action, coil spring mechanism with stainless steel spring
Contacts	Silver
Terminals	6.3 mm (x0.8) faston brass
Temperature range °C	-20°C to +85°C
Protection	IP40 (enclosure)
Mounting	Screw mounting
Actuators	Plunger

Circuit diagram

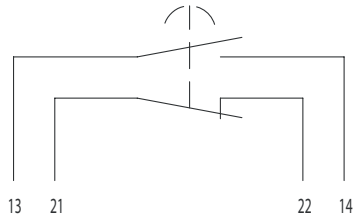

Dimensions

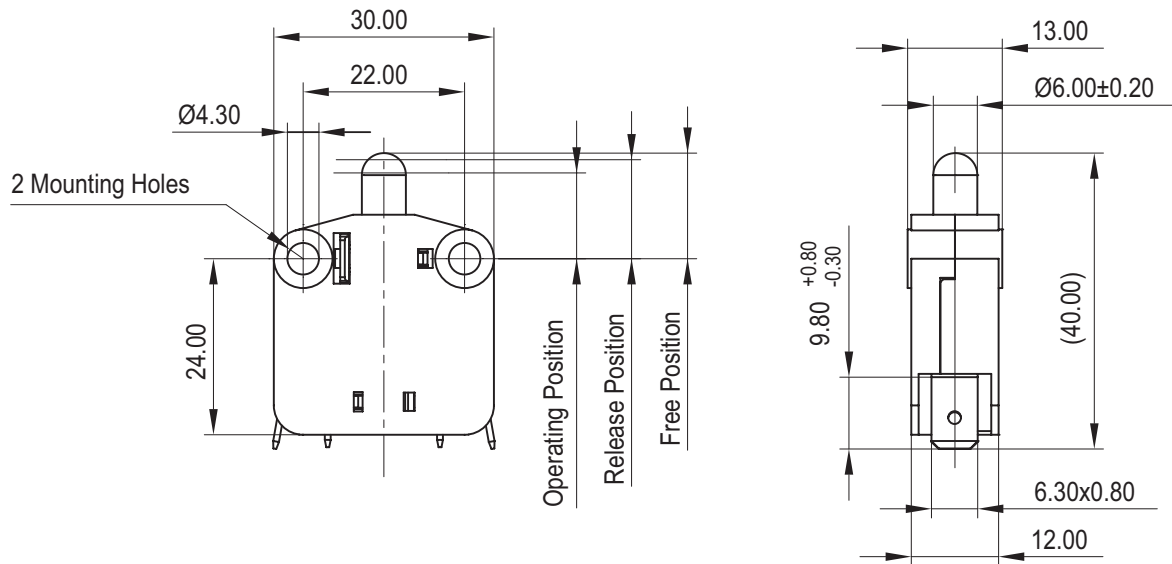

## Recommended maximum electrical ratings

Voltage (max)	(A)
240 VAC	3
120 VAC	6
120 VDC	2,2
240 VDC	1,1

## Operating Characteristics

Actuator	Reference	Actuating Force Maximum (N)	Release Force Minimum (N)	Free Position Maximum (mm)	Operating Position (mm)	Release Position (mm)	Operating travel Minimum (mm)
Plunger	XPC24	6,0	3,5 ± 0,5	14,5	11,7 ± 0,5	13,5 ± 0,5	6,0



## Ordering Reference

Type XPC24